

Drawing name: K:\WDC_CIV\creekCAD\plansheets\C3-00 - GRADING AND DRAINAGE PLAN.dwg C3-00 GRADING AND DRAINAGE PLAN Jun 19, 2025 2:05pm By: Noah Dull

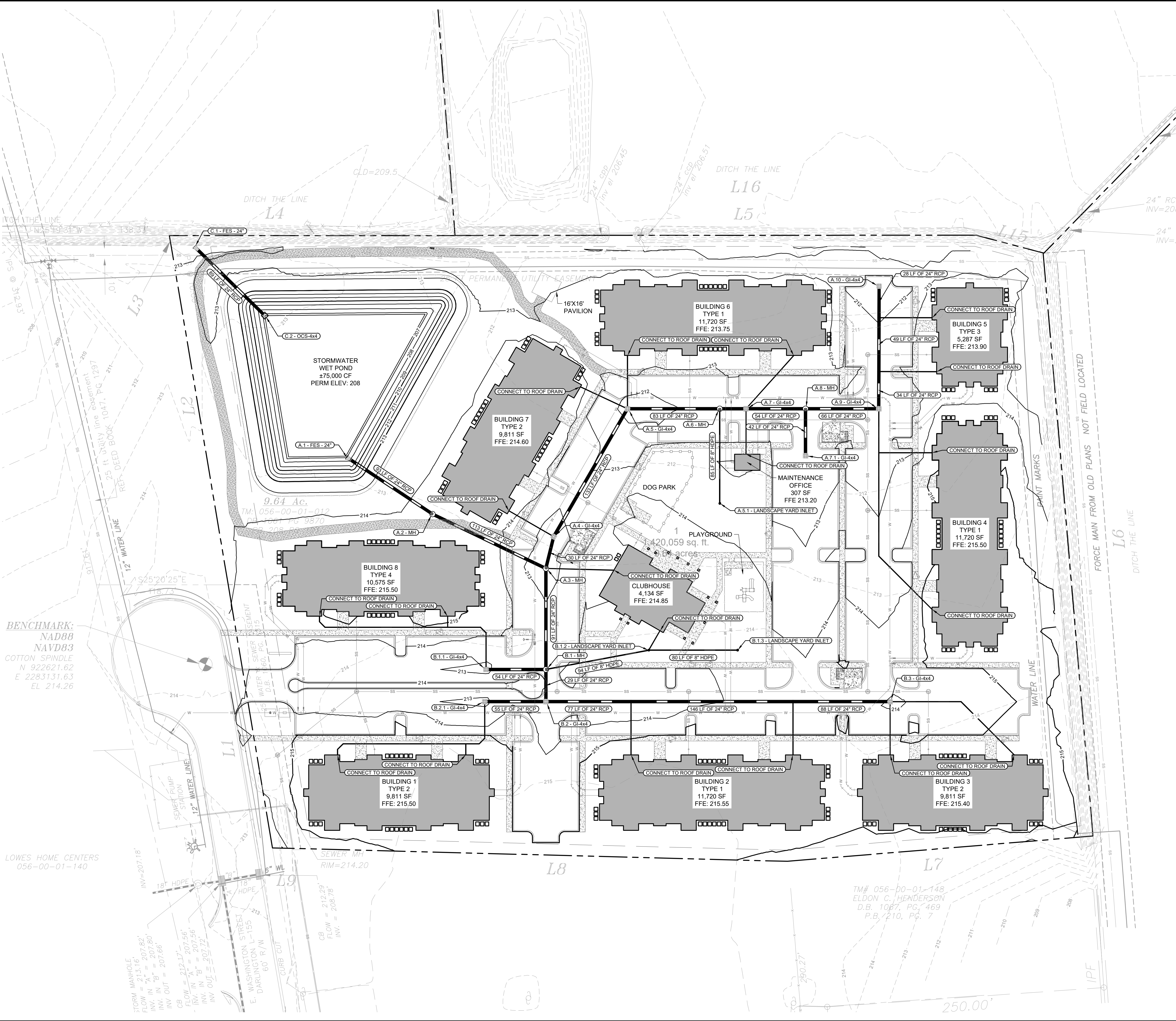

GRADING & DRAINAGE NOTES:

1. SITE AREA: 9.64 ACRES
DISTURBED AREA: 9.4 ACRES
2. CRITICAL SPOT GRADES ARE TO PAVEMENT GRADE UNLESS OTHERWISE NOTED.
3. CONTRACTOR SHALL CONSTRUCT ALL SIDEWALKS AND CROSSWALKS WITH A 2.00% MAXIMUM CROSS SLOPE AND A 5.00% MAXIMUM RUNNING SLOPE, UNLESS NOTED AS A RAMP. GRADES WITHIN ADA HANDICAP PARKING AREAS NOT TO EXCEED A 2.00% MAXIMUM SLOPE IN ANY DIRECTION.
4. CONTRACTOR SHALL TAKE FIELD SLOPE MEASUREMENTS ON FINISHED SUBGRADE AND FORM BOARDS PRIOR TO PLACING PAVEMENT TO VERIFY THAT ADA SLOPE REQUIREMENTS ARE PROVIDED. CONTRACTOR SHALL CONTACT ENGINEER PRIOR TO PAVING IF ANY EXCESSIVE SLOPES ARE ENCOUNTERED. NO CONTRACTOR CHANGE ORDERS WILL BE ACCEPTED FOR ADA SLOPE COMPLIANCE ISSUES
5. ALL ROOF DRAIN PIPING SHALL BE PVC UNLESS OTHERWISE NOTED.
6. ALL ROOF DRAIN CLEANOUTS IN PAVED AREAS SHALL HAVE A BRASS CAP SET FLUSH WITH THE PROPOSED GRADE.
7. ALL PIPE LENGTHS SPECIFIED IN THESE PLANS ARE THE HORIZONTAL DISTANCE AND ARE SHOWN FOR REFERENCE ONLY. IT IS THE RESPONSIBILITY OF THE CONTRACTOR TO DETERMINE ACTUAL LENGTHS BASED ON PROPOSED PIPE SLOPE. PIPE LENGTHS IN PLANS ARE MEASURED FROM CENTER OF STRUCTURE TO CENTER OF STRUCTURE UNLESS OTHERWISE NOTED.
8. THIS PROJECT DOES NOT LIE WITHIN A 100 YEAR FLOOD HAZARD ZONE AS DEFINED BY THE F.E.M.A. "FLOOD HAZARD BOUNDARY MAP" COMMUNITY PANEL NUMBER 45031C0285C, DATED 02/06/2013.
9. UTILITIES MAY EXIST WHICH ARE NOT SHOWN ON THE PLANS. THE CONTRACTOR SHALL BE RESPONSIBLE FOR CONTACTING ALL UTILITY COMPANIES HAVING UTILITIES WITHIN OR ADJACENT TO THE WORK AREA. THE CONTRACTOR SHALL HAVE THE UTILITIES FIELD LOCATED AND COORDINATE WITH THE UTILITY COMPANIES TO HAVE CONFLICTS RELOCATED WHEN NECESSARY OR ADAPTED FOR TIE-INS.
10. CONTRACTOR TO FIELD VERIFY EXISTING INVERT FOR SANITARY SEWER AND STORM DRAINAGE SERVICE CONNECTIONS PRIOR TO CONSTRUCTION. CONTRACTOR SHALL NOTIFY ENGINEER OF DISCREPANCY PRIOR TO PROCEEDING.
11. NO GRADED SLOPE SHALL EXCEED 2H:1V
12. ALL WALLS GREATER THAN 30" IN HEIGHT SHALL BE DESIGNED AND PERMITTED BY AN ENGINEER LICENSED IN THE STATE OF SOUTH CAROLINA.
13. ALL WALLS GREATER THAN 30" IN HEIGHT SHALL HAVE FALL PROTECTION THROUGH FENCING OR HANDRAIL AT A MINIMUM OF 42" TALL. REFERENCE LANDSCAPE PLANS FOR DETAILS.

GRADING LEGEND:

- | | |
|-----------------|--------------------------------|
| — 215 — | EXISTING MAJOR CONTOUR |
| - - - 215 - - - | EXISTING MINOR CONTOUR |
| — 215 — | PROPOSED MAJOR CONTOUR |
| - - - 215 - - - | PROPOSED MINOR CONTOUR |
| ⊙ | MANHOLE |
| ⊙ | 4' X 4' GRATE INLET |
| ⊙ | TYPE 18 CATCH BASIN |
| ⊙ | OUTLET CONTROL STRUCTURE |
| ⊙ | FLARED END SECTION |
| --- | PROPOSED ROOF DRAIN PIPE |
| --- | PROPOSED STORM PIPE |
| W | PROPOSED WATER LINE |
| SS | PROPOSED SANITARY SEWER PIPE |
| → | DRAINAGE FLOW ARROW |
| × 215.00 | PROPOSED SPOT GRADE |
| × TG 215.00 | PROPOSED TOP GRADE AT WALL |
| × BG 215.00 | PROPOSED BOTTOM GRADE AT WALL |
| × TS 215.00 | PROPOSED TOP OF STAIR GRADE |
| × BS 215.00 | PROPOSED BOTTOM OF STAIR GRADE |
| × HP 215.00 | PROPOSED HIGH POINT GRADE |
| × LP 215.00 | PROPOSED LOW POINT GRADE |
| × TC 215.00 | PROPOSED TOP OF CURB GRADE |
| × BC 215.00 | PROPOSED BOTTOM OF CURB GRADE |

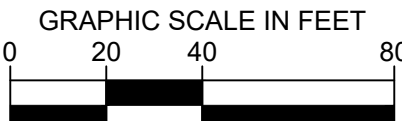
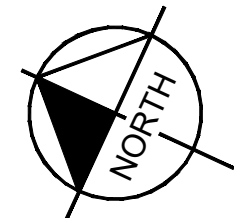

PROJECT: CAMELIA RIDGE APARTMENTS 939 S FOURTH ST, HARTSVILLE, SC 29550	CLIENT: KCG DEVELOPMENT 8311 N MERIDIAN ST INDIANAPOLIS, IN 46260 PHONE: (463) 274-5866	TITLE: GRADING AND DRAINAGE PLAN	SHEET NUMBER: C3-00	KHA PROJECT NO.: 111104000 DATE: 06/19/2025 SCALE: AS SHOWN DRAWN BY: NSD DESIGNED BY: MJG CHECKED BY: JCC	No. REVISIONS	DATE	BY

Kimley»Horn
© 2025 KIMLEY-HORN AND ASSOCIATES, INC.
1100 NEW JERSEY AVENUE, SE, SUITE 420
WASHINGTON, DISTRICT OF COLUMBIA 20003
PHONE (202) 971-8225
WWW.KIMLEY-HORN.COM

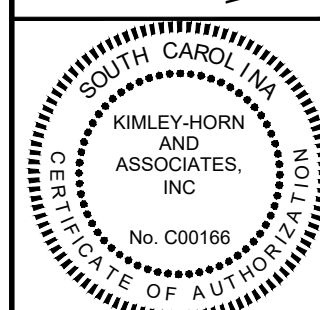

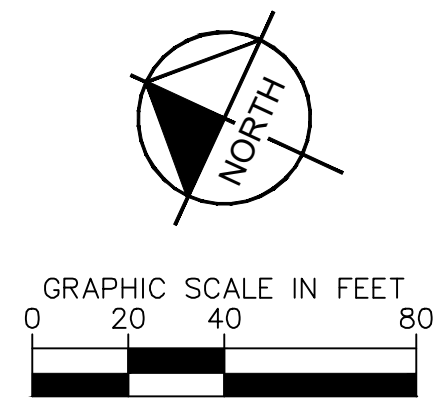
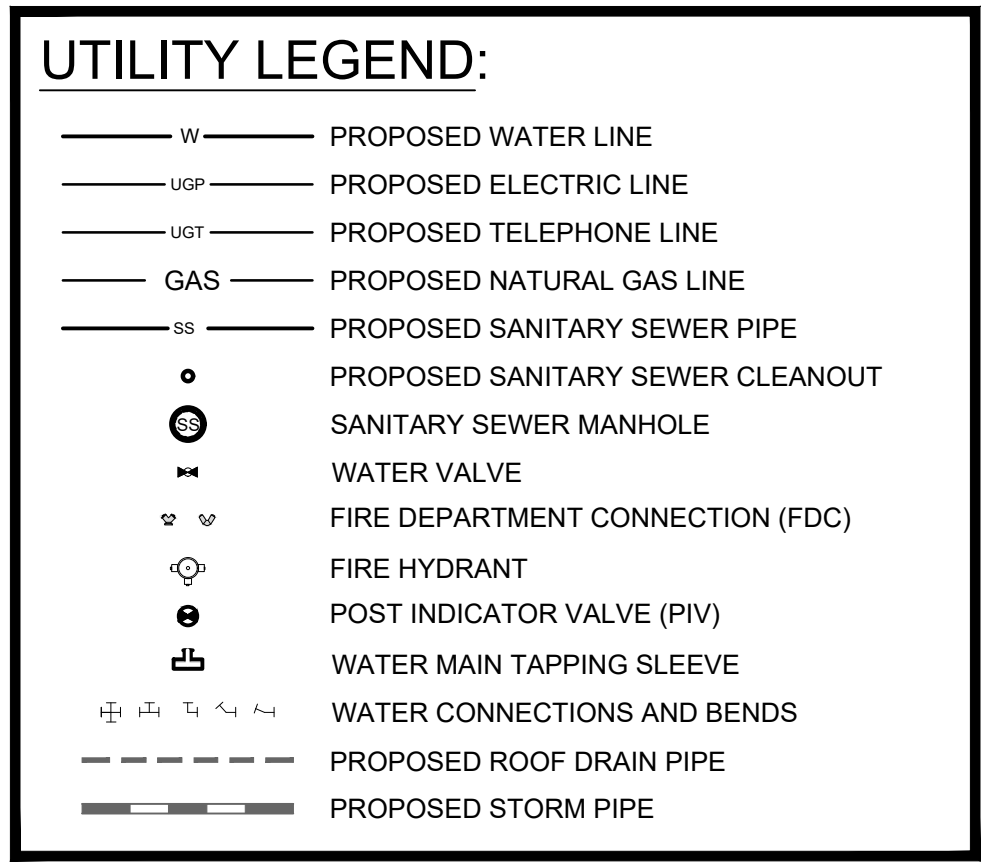
[illegible]